

Planting & Tillage

SUNFLOWER AND WHITE PLANTER



Planting & Tillage

SUNFLOWER AND WHITE PLANTER

AGCO Parts dealers are your only source for Sunflower tillage and White Planter Parts. They have what you need to keep your tillage and planter equipment operating at design specs and at maximum performance.

The quality OEM parts in this catalog will ensure a true fit and a long-life. All AGCO Parts are backed by a full 12-month warranty.

Table of Contents

Sunflower Tillage and Grain Drills	Page
Chisel Spikes	2
Disc Blades	1
Drill Press Wheels	10
Drill Unit Components	9
Hub Assembly	4
Moldboards.....	2
Plow Blades	1
Rims.....	5-6
Scraper Blades	3
Shanks.....	6-8
Spindles	4
Subsoiler Points	2
Sweeps	2
Tires.....	5-6
Treaders.....	2
Trunnion Bearing	6
Twisted Chisels	3
White Planters	Page
AGCO Graphite Seed Flow Lubricant	11
AGCO Talc Lubricant	11
Closing Wheels	14
Disc Opener Assemblies	12
Disc Opener / Coulter Blades	12
Drive Wheel Assembly	15
Gauge Wheels	13-14
Marker Blades	13
Planter Chain, Cut-to-Length	16
Scrapers	13
Seed Discs	12
Seed Meter Components	11
Springs	15

Sunflower



Part No.	Size	Gauge
3-Sided Disc Blades- 1-3/4" Bore		
SN6639N	18"	7
SN6640N	20"	4
SN6641N	20"	4

Part No.	Size	Gauge
Notched Disc Blades- 1-3/4" Bore		
SN1968	24"	6
SN1967	22"	7

Part No.	Size	Gauge
Plain Disc Blades		
SN7773N	14"	10
SN3283N	18"	4
SN3271N	19.69"	4
SN3270N	19.69"	7
SN4662N	20"	4
SN4661N	20"	6
SN7602N	20.18"	4
SN3273N	20.44"	4
SN2812-1N	20.44"	6
SN2686N	22"	4
SN9820N	22"	6
SN7599N	22.33"	4
SN1964N	24"	4
SN9821N	24"	6
SN7588N	24.38"	4
SN7587N	24.38"	6

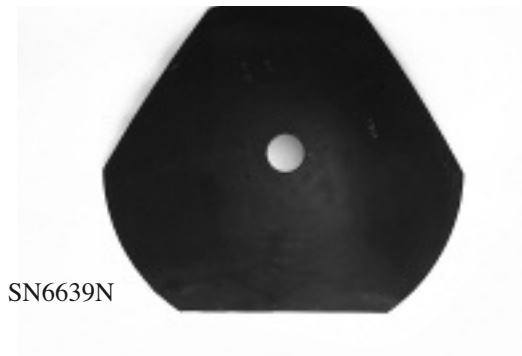

SN6639N

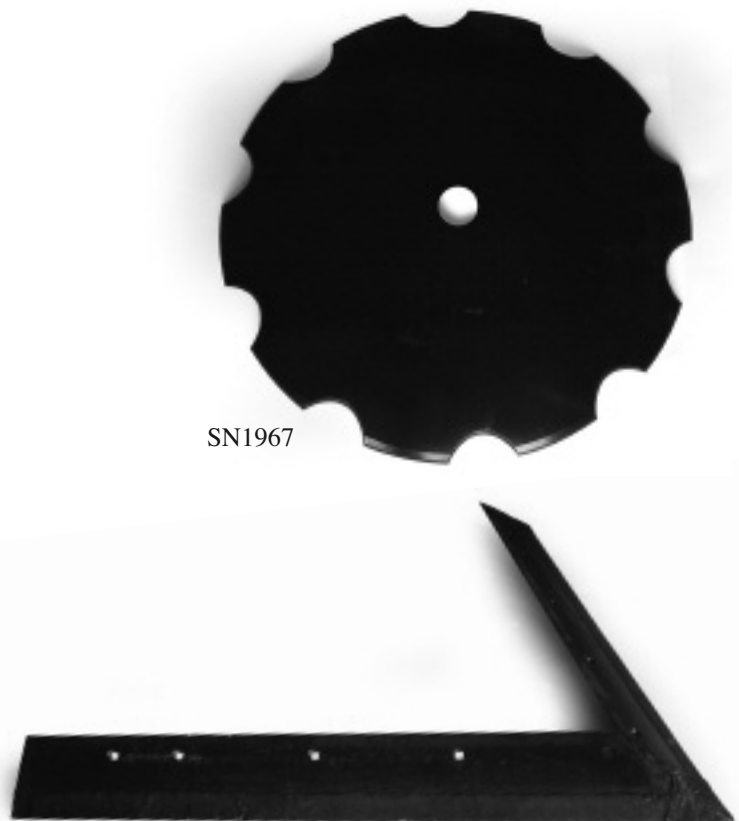

SN1967

SN168

Part No.	Description
Plow Blades	
SN168	75 Deg., 5' Cut, 50" Blade, Hardfaced Top Side
SN169	75 Deg., 5' Cut, 50" Blade, Hardfaced Bottom Side
SNAE1363TL	75 Deg., 5-1/4', Left Hardfaced Top Side
SNAE1363BL	75 Deg., 5-1/4', Left Hardfaced Bottom Side
SN224	75 Deg., 5-1/2', Hardfaced Top Side
SN225	75 Deg., 5-1/2', Hardfaced Bottom Side
SN227	75 Deg., 6' Cut, 60" Blade, Hardfaced Top Side
SN228	75 Deg., 6' Cut, 60" Blade, Hardfaced Bottom Side

Sunflower



SN4821



SN2244-1



SN2246-1



SN7012



SN3048



SN12625



SN4804

Part No. Description

Rolling Treader

SN4820	Eight Tooth Wheel (Right)
SN4821	Eight Tooth Wheel (Left)
W238799B	Gang Bearing & Flange Assembly

Part No. Description

Chisel Plow Moldboard

SN2244-1	4" Moldboard (Right)
SN2245-1	4" Moldboard (Left)
SN2246-1	4" Moldboard Point (Right)
SN2247-1	4" Moldboard Point (Left)
SN2248	Moldboard Frog (Right)
SN2249	Moldboard Frog (Left)

Part No. Description

Fallow Sweeps - 50°, 1/2" Holes, 2-1/4" Centers

SN5543	26" Hard Face (Bottom) Straight Wing 5/16"
SN7012	32" Hard Face (Bottom) Straight Wing 5/16"

Part No. Description

Cultivator Sweeps - 47°

SN3055	4" Plain
SN3046	9" Plain
SN3048	10" Plain
SN4745	10" Plain Ultrawing
SN3049	10" Hardfaced

Part No. Description

Subsoiler Points

SN12625	1" x 2-3/8" x 12" w/ Wing & Chrome Cap
SN12764	1" x 2-1/2" x 12" w/ Wing & Chrome Cap
SN12762	1" x 2-1/2" x 12" w/ Chrome Cap
SN5273	1" x 2-1/2" x 12"

Part No. Description

Chisel Spikes

SN1053-1	7/8" x 2" x 19-1/2"
SN1053	5/8" x 2" x 17-1/2"
SN4803	1/2" x 4" Right Twisted
SN4804	1/2" x 4" Left Twisted

Sunflower

Part No. Description

Twisted Chisels

SN1725	1/2" x 3" Right Twisted
SN1726	1/2" x 3" Left Twisted

Part No. Description

Scraper Blades

SN6733	Scraper Blade w/ Arm, 10-3/8" Right Rigid
SN6734	Scraper Blade w/ Arm, 10-3/8" Left Rigid
SN6103	Scraper Blade Only, 4" Rigid

Part No. Description

Spikes & Tines

SN5715	Harrow Tooth Tine 3/8" x 16"
SN3895	Spike Tooth, 3/4" x 11"
SN10161	Round Spike Tooth, 3/4"

Part No. Description

Snub Nose Furrower

SN9556	1/4" x 8"
--------	-----------

Part No. Description

Trash Arms

SN3088	Single Trash Arm
SN3958	Flat Trash Arm for Bearing Standards

Part No. Description

Chopper Reel

SN5529	Reel Blade
SN5573	60" Reel w/ Blades
SN5574	75" Reel w/ Blades

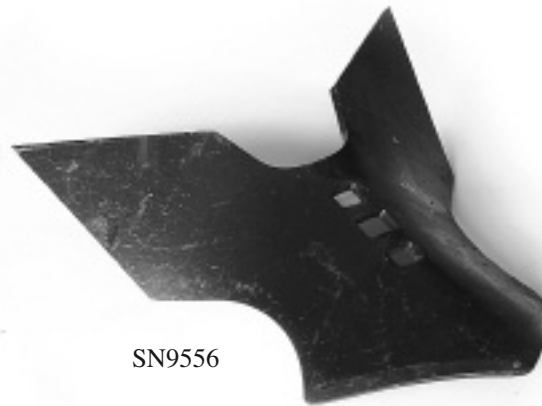

Sunflower

Main Drive Wheel Assembly



SN3299

Part No.	Description	MUO
Spindles		
SN3299	2" x 13-1/4"	1321, 1331, 1434, 1444, 2433, 3030, 3040, 3050, 3060, 3070, 3372, 3392, 4213, 5035, 5055, 5135
SN3298	2" x 11-3/16"	1233, 1234, 1321, 1331, 4110, 4213, 4233, 4411, 4412, 4511, 6221, 6333, 6433, 7212, 7232, 7252
SN3687	2-1/4" x 14"	1434, 1444, 1544, 3050, 4233, 4411, 4511, 5055, 5135
SN3289	1-3/4" x 11-3/16"	1211
SN4776	2" x 14- 5/8" (Single Transport)	3030, 3040, 3050, 3060, 3070
SN5621	2-3/4" x 15-5/16"	3372 (40 Blade), 3392, 6333, 6433
SN5536	2" x 10-1/16"	3612 (Single Wheel), 3662, 3672, 3692 (Single Wheel)
SNQ24-104	2-1/8" x 10-33/64"	3612 (Dual Wheel), 3692 (Dual Wheel)

4



SN3300

Part No.	Description	MUO
Hub Assemblies		
SN3300	Six Bolt Hub Assembly	1233, 1234, 1321, 1331, 1434, 1444, 2433, 3030, 3040, 3050, 3060, 3070, 3372, 3392, 3612, 3662, 3672, 3692, 4213, 4233, 4411, 4412, 4511, 5035, 5055, 5135, 6221, 6333, 6433, 7212, 7232, 7252
SN2199	Six Bolt Hub Assembly for 1-3/4" Spindle	1211
SN3686	Eight Bolt Hub Assembly	1434, 1444, 1544, 3050, 4233, 4411, 4511, 4530, 5055, 5135
SNFK800384	Eight Bolt Hub Assembly for 2-3/4" Spindle	3372 (40 Blade), 3392, 6333, 6433
SNAE-5110	Six Bolt Hub Assembly w/ 2-1/8" Spindle	3612 (Dual Wheel), 3692 (Dual Wheel)

Sunflower

Main Drive Wheel Assembly

SN2198



Part No.	Description	MUO
Rims		
SN1944	15 x 10, 6 Bolt	1211, 1233, 1234, 1321, 1331, 1434, 1444, 2433, 3030, 3040, 3050, 3060, 3070, 3372, 3392, 3612(Dual Wheel), 3692 (Dual Wheel), 4213, 4233, 4411, 4412, 4511, 5055, 5135, 6221, 6333, 6433
SN2198	15 x 8, 6 Bolt	1211, 1321, 1331, 3612 (Single Wheel), 3662, 3672, 3692 (Single Wheel), 5035, 5055, 5135
SN3688	15 x 10, 8 Bolt, 1-1/8" Offset	1434, 1444, 1544, 3050, 4233, 4411, 4511, 4530, 5055, 5135, 6333
SN5094	15 x 6, 6 Bolt	3030, 3040, 3050, 3060
SN5603	15 x 10, 8 Bolt, 3/8" Offset	3372 (40 Blade), 3392, 5055, 6433

Part No.	Description	MUO
Tires		
SN3582	12.5L x 15, 12 Ply, Tubeless	3372, 3392, 4110, 4213, 4411, 4412, 6333 (31'-37'), 6433
SN5578	12.5L x 15, 12 Ply, Tubeless	1434, 1444, 1544, 3372 (40 Blade), 3392, 4411, 4511, 4530
SN3578	9.5L x 15, 8 Ply, Tubeless	1211, 1321, 1331, 3030, 3040, 3050, 3060, 3070, 4213, 4411, 7212, 7232, 7252
SN3579	9.5L x 15, 12 Ply, Tubeless	1211, 3070, 7212, 7232, 7252
SN3580	11L x 15, 8 Ply Tubeless	1211, 1233, 1234, 1321, 1331, 1434, 1444, 2433, 3030, 3040, 3050, 3060, 3070, 3612, 3692, 4110, 4213, 5035, 5055, 5135, 6333
SN3581	11L x 15, 12 Ply Tubeless	1211, 1233, 1234, 1321, 1331, 1434, 1444, 2433, 3040, 3612, 3662, 3672, 3692, 4110, 4213, 4233, 4511, 5035, 5135, 6221
SN9266	11L x 15, 18 Ply Agriflex	3050, 5055, 5135, 6333

Sunflower

Part No.	Description	MUO
Rim & Tire Assemblies		
SN3588	Part No. SN1944 & SN3582	3372, 3392, 4110, 4213, 4411, 4412, 6433
SN5555	Part No. SN3688 & SN5578	1434, 1444, 1544, 4233, 4411, 4511, 4530, 5055
SN3058	Part No. SN1944 & SN3580	1233, 1234, 1434, 1444, 2433, 3030, 3040, 3050, 3060, 3070, 4110, 4213, 5055, 5135, 6333
SN3584	Part No. SN2198 & SN3578	1211, 1321
SN3585	Part No. SN2198 & SN3579	1211
SN3587	Part No. SN1944 & SN3581	1233, 1234, 1321, 1331, 1434, 1444, 1211, 2433, 3040, 3612, 3692, 4213, 4233, 4511, 5135, 6221
SN5152	Part No. SN3579 & SN5094	3070, 7212, 7232, 7252
SN5151	Part No. SN3578 & SN5094	3030, 3040, 3050, 3060, 3070, 7212, 7232, 7252
SN5552	Part No. SN9266 & SN3688	3050, 5055, 5135, 6333
SN5579	Part No. SN5578 & SN5603	3372 (40 Blade), 3392, 5055
SN6191	Part No. SN2198 & SN3580	3612, 3692, 5035
SN6190	Part No. SN2198 & SN3581	3612, 3662, 3672, 3692
SN5578	Part No. SN3582 & SN5603	6433

6



SN3090

Part No. Description

Trunnion Bearing

SN3090	Complete Trunnion Bearing
SN3091	Trunnion Bearing Insert
SN3096	Trunnion Bearing Mount



SN5976

Part No. Description MUO

C-Flex Shank

SN10400	1" x 3"	4411
SN5978	1" x 2-1/2" Left	4411, 4412, 4511, 4530
SN5977	1" x 2-1/2" Right	4411, 4412, 4511, 4530
SN5975	1-1/4" x 2-1/2" Right	1233, 1234, 1444, 1544, 4411, 4412, 4511, 4530
SN5976	1-1/4" x 2-1/2" Left	1233, 1234, 1444, 1544, 4411, 4412, 4511, 4530
SN4971	1 x 3"	4110
SN2761	1" x 2"	1211, 4213, 4233, 7212, 7232, 7252
SN2729	1-1/4" x 2" Right	1321, 1331
SN2730	1-1/4" x 2" Left	1321, 1331

Sunflower



Part No.	Description	MUO
Rigid Shear Bolt Shank		
SN5540	1-1/2" x 2" x 30", Edge Bent	2433, 3030, 3040, 3050, 3060, 3070, 4511, 4530

Part No.	Description	MUO
Spring Trip Shank		
SN1730	1-1/4" x 2" x 26"	2433
SN3159	Spring, 1-7/8"ID x 17"L (for SN1730)	

Part No.	Description	MUO
Spring Shank		
SN6685	1-1/4" x 2" x 30" Edge Bent	2433
SN6684	Spring (for SN6685)	
SN12231	5/8" x 1-3/4", Flat	5035, 5055, 5135, 6221, 6333, 6433
SN10579	5/8" x 1-3/4", On Edge	5035, 5055, 5135
SN3043	Spring (for SN12231, SN10579)	

Part No.	Description	MUO
Rigid Shank		
SN3110	1-1/4" x 2" x 30"	2433
SN5676	1-1/2" x 2" x 30", Edge Bent	4213, 4233

Sunflower

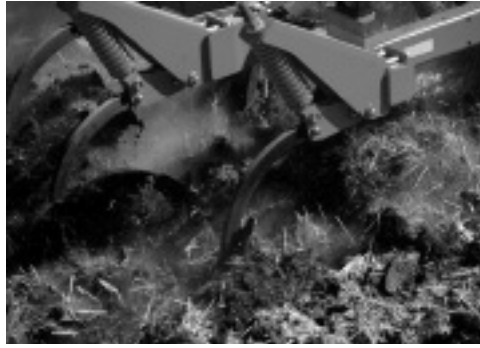

8

Part No.	Description	MUO
Auto Reset Shank		
SN5202	1-1/4" x 4" x 40"	4110, 4411, 4412
SN3335	Spring (for SN5202 single spring)	
SN3159	Spring, (for SN5202 double spring)	
SN5015	1-1/4" x 4" x 36"	4411
SN5419	Spring (for SN5015 double spring)	
SN12473	1-1/4" x 2-1/2" X 30"	4213, 4233, 4511, 4530
SN5419	Spring (for SN12473 single spring)	

Part No.	Description	MUO
Manual Reset Shank		
SN5202	1-1/4" x 4" 40"	4110, 4411
SN3335	Spring (for SN5202)	



Part No.	Description	MUO
Two Piece S-Tine Shank		
SN12257	5/8" x 1-3/4" x 24", Flat	5035, 5055, 5135, 6221, 6333, 6433
SN6806	5/8" x 1-3/4" x 24", On Edge	
SN7453	Spring Clamp	

Part No.	Description	MUO
One Piece S-Tine Shank		
SN3821	5/8" x 1-3/4" x 24"	4110

Sunflower

Grain Drills

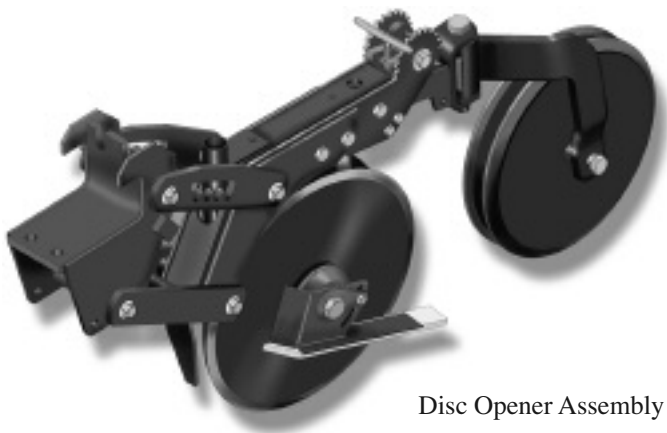

Disc Opener Assembly



SNA0012

Part No.	Description
----------	-------------

Disc Opener Assemblies

SN9753N	15" Heads-Up
SN7261	15" All Purpose
540-647	13-1/2" Disc Assembly

Part No.	Description
----------	-------------

Disc Opener Blades

555-002	13-1/2" Disc Opener Blade
SN7176N	15" Disc Opener Blade

Part No.	Description
----------	-------------

Drill Unit Components

SN7201	Soil Control Strip Support
SN7859	Soil Control Strip
SNB1127	Dust Cap
SN10127	Left Disc Opener Scraper
SN10126	Right Disc Opener Scraper

Part No.	Description
----------	-------------

Seed Tube Assembly

SN13571	Rubber Seed Tube 8.5"
SN9937	Seed Tube, All Purpose Heads Up
SN7038	Seed Tube, All Purpose
SNDR12011	Seed Tube Clamp
SNA0012	Seed Meter Assembly
204-133	Seed Meter Plug

Sunflower

Press Wheels

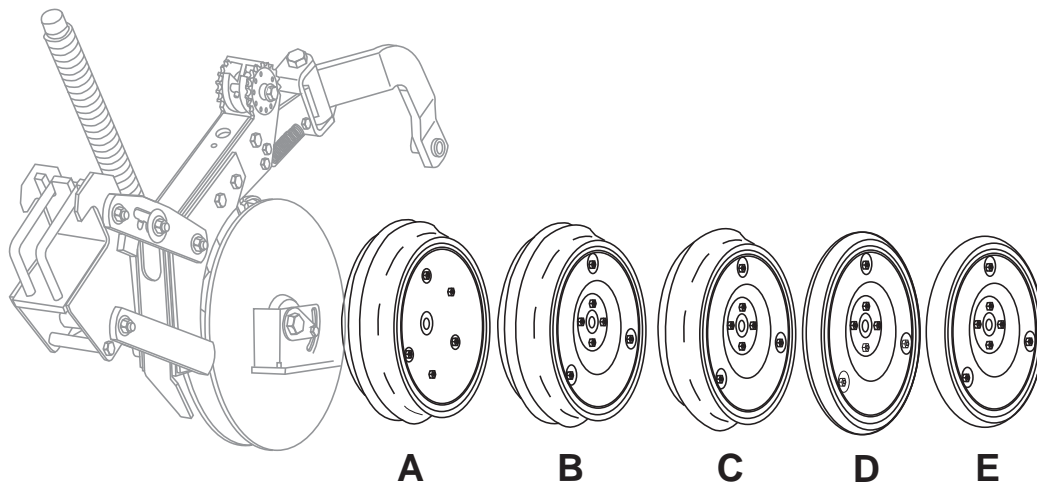

10

Part No. Description

Press Wheels

SN6869	(A) 4" x 12" Double Rib Nylon Rim Assembly
SN13219	(B) 3" x 13" Double Rib Steel Rim Assembly
SN6866	(C) 3" x 13" Center Rib Steel Rim Assembly
SN6868	(D) 2" x 13" V-Crown Steel Rim Assembly
SN6867	(E) 2" x 13" Smooth Crown Steel Rim Assembly
854003	Press Wheel Bearing
SN7408	(A) 4" x 12" Double Rib Tire
SN7407	(B) 3" x 13" Double Rib Tire
SN7410	(C) 3" x 13" Center Rib Tire



White Planters



853621



W247713B

Part No. Description

Seed Meter Unit

W247713B	Auxiliary Tickler Brush, Fits 5100, 5700, 6000, 8000 Series
853639	Air Cutoff Brush, Fits 8000 Series
N858771	Air Cutoff Brush, Fits 5100, 5700, 6000 Series
N855782	Seed Disc Drive Shaft and Bearing, Fits 6000 Series
N852996	Seed Disc Drive Shaft and Bearing, Fits 5100, 5700, 8000 Series
853621	Seed Tube w/High Rate Sensor, Fits 6000, 8000 Series
700729710	Seed Tube Only, Fits 6000, 8000 Series
W248002B	Seed Tube Only, Fits 5100, 5700, 6000 Series
W247702B	Seed Tube w/Sensor, Pin-Type Connector, Fits 5100, 5700 Series
W248509B	Seed Tube w/ Standard Sensor, Weather-Pak Connector, Fits 5100, 5700, 6000 Series
W239661B	Seed Tube Cleaner Brush, Fits 5100, 5700, 6000, 8000 Series



79024007

AGCO Planter Talc helps maintain seed flow by minimizing seed treatment buildup on seed meter components.



79021832

AGCO Seed Flow Lubricant is a graphite powder used in the planter seed hopper to help reduce friction, allowing seeds to flow smoothly and reduce planter part wear.
Order on Promo 165

White Planters



852435

Part No. Cells Description

Seed Discs

852435	30	Medium Field Corn, Large Sunflower
852434	30	Large Field Corn
852436	30	Small Field Corn
852437	30	Popcorn, Small Field Corn, Small Sugar Beets, Small/Medium Sunflower
852432	60	Soybeans (2 Seeds Per Cell), Large Navy Beans
700722513	60	Soybeans (1 Seed Per Cell), Small Navy Beans
852440	120	Milo, Sorghum

Part No. Description/MUO

Disc Opener Assemblies

700164109	13-1/2" Seed / Fertilizer Opener, 5100, 5700 Series Fertilizer Opener, 6000, 8000 Series
700167073	15"x 3mm Seed Opener, 6000 Series
700164107	15"x 3.5mm Seed Opener, 8000 Series

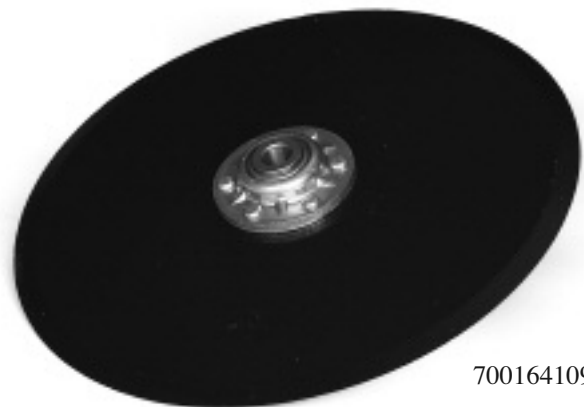

700164109

Part No. Description/MUO

Disc Openers / Coulter Blades

700155035	Disc Opener Blade 15" x 3.5mm, Fits 8000 Series
30-1005553	Disc Opener Blade 13-1/2" Seed and Fertilizer Opener, Fits 5100, 5700 Series Fertilizer Opener Fits 6000, 8000 Series
852064	Disc Opener Blade 15" x 3mm Seed Disc Opener, Fits 6000 Series
W247988B	Coulter Blade 15" x 7ga x 3-15/16" (15/16 Flutes), Fits 5100, 5700, 6000, 8000 Series
W247989B	Coulter Blade 15" x 7ga x 3-15/16" (13/16 Flutes), Fits 5100, 5700, 6000, 8000 Series

White Planters



W248434BS

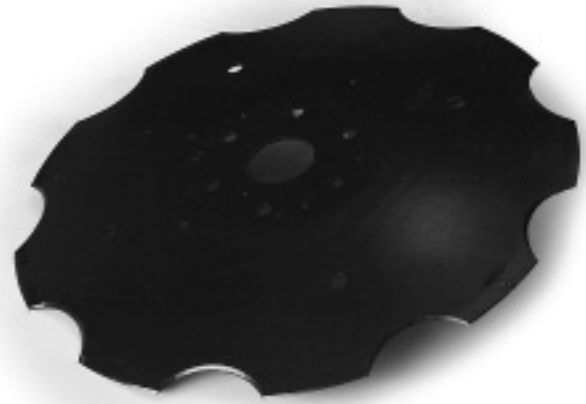

853999

Part No. Description/MUO

Marker Disc Blade Assemblies

W246834BS	12" Plain Disc Assembly, Fits 5100 / 5700 (Hydraulic Marker) Series Disc Blade Only (Part No. W245886B)
W232736BS	14" Plain Disc Assembly, Fits 5100 / 5700 (Hydraulic Folding Marker) Series Disc Blade Only (Part No. W247597B)
853999	14" Notched Disc Blade Only, Fits 6000, 8000 Series
W248425B	14" Plain Disc Blade Only, Fits 5100 / 5700 (No-Till Marker), 6000, 8000 Series
BD5867	Notched Disc, Fits 8000 (Flat Fold Marker) Series
W247167B	Bearing
W248424B	Hub
W247165B	Hub Cap

Part No. Description/MUO

Scrapers

W248434BS	Scraper Kit, Includes Scraper, Bearing, Retainer, and Cotter Pin. (Pkg Qty 2). Fits 8000 Series
W247460B	Inside Double Disc Fertilizer Opener Scraper. Fits 5100, 5700, 6000, 8000 Series
W247461B	Outside Double Disc Fertilizer Opener. Fits 5100, 5700, 6000, 8000 Series
W248432B	Left Support Scraper Bracket. Fits 5100, 5700 Series
W248433B	Right Support Scraper Bracket. Fits 5100, 5700 Series
853023	Left Support Scraper Bracket. Fits 6000, 8000 Series
853024	Right Support Scraper Bracket. Fits 6000, 8000 Series



W247812B

Part No. Description

5100 / 5700 Series Gauge Wheels and Press Wheels

W247812B	Gauge Wheel Tire, 4 x 16
W247811B	Gauge Wheel Half, 4 x 16
W248364B	Gauge Wheel Cover
W232401B	Press Wheel, 4 x 12
W247657B	Double Rib Semi-Pneumatic Press Wheel Tire, 4 x 12
W248105B	Single Rib Semi-Pneumatic Press Wheel Tire, 4 x 12

White Planters



700727657

14

Part No. Description

8000 Series – Gauge Wheels

700727657	Wheel and Tire Assembly, 4.5 x 16, includes: Steel Wheel Half Nylon Wheel Half Tire Bearing
3700727660	Steel Wheel Half
700727659	Nylon Wheel Half
700727658	Tire
854003	Bearing



700727676

Part No. Description

6000, 8000 Series – Dual Closing Wheels – Rubber or Cast

700727676	Rubber Closing Wheel Assembly
854077	Cast Closing Wheel Assembly
700727675	Closing Wheel Halves, 2 Pieces
700727674	Closing Wheel Tire, 1 x 12
854003	Bearing

Part No. Description

6000, 8000 Series – Single Closing Wheels -- Rubber

W247657B	Double Rib Semi-Pneumatic Closing Wheel, 4 x 12
W232401B	Gauge Wheel Half. Fits 6000 Series
853996	Gauge Wheel Half. Fits 8000 Series
W247658B	Bearing



W247657B

White Planters



Part No. Description/MUO

Drive Wheel Assembly

852833	15 x 8 Rim. Fits 5100, 5700, 6000, 8000 Series
W247732B	Wheel Hub Assembly. Fits 5100, 5700, 6000, 8000 Series
K3538	Wheel Bearing. Fits 5100, 5700, 6000,
W247647B	Wheel Bearing. Fits 8000 Series
70345406	Hub Bolts (Pkg of 6). Fits 5100, 5700, 6000, 8000

15

Part No. Description/MUO

Springs

W245395B	8-1/2" Spring. Fits Standard Down Pressure on 5100, 5700; Transmission on 5100, 5700; Hydraulic Folding Markers 5100, 5700, 6000, 8000 Series
DAB10071GA	Standard Down Pressure Spring with Cast Plug. Length 6-1/4" and Threaded for 7/16" Bolt. Early Model 6000 Series.
271276	Standard Down Pressure Spring with Cast Plug. Length 6-1/4" and Threaded for 7/16" Bolt. Fits Late Model 6000 Series, 8000 Series with 1/2" Threaded Hole Cast Plug
W247662B	Heavy Duty Down Pressure Spring. Fits 6000, 8000 Series. (4 per row)
N856594	Fits Single Closing Wheels on 5100, 5700, 6000 Series. Closing Wheel Spring. Fits 6000, 8000 Series



W245395B

White Planters

Cut-to-Length Planter Chain

2040

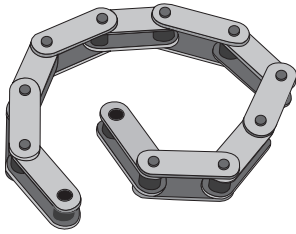

2041

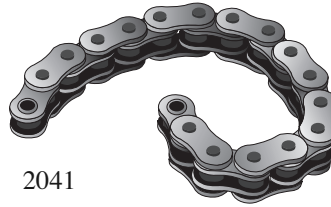

2050

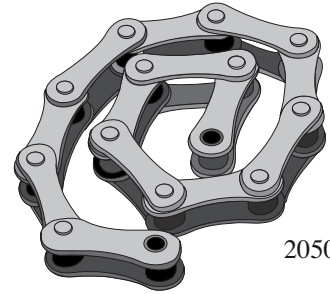

Order on Promo 249

US Part No. Description/MUO

Import Part No.

Transmission Chain

DC2040-49	Rear Countershaft To Seed Meter Feed Shaft. Fits 5100, 5700 Series	SP2040-49
DC2040-69	Rear Countershaft To Front Main Drive Shaft. Fits 5100, 5700 Series	SP2040-69
DC2040-45	Rear Countershaft To Seed Meter Feed Shaft. Fits 6000 Series	SP2040-45
DC2040-61	Rear Countershaft To Front Main Drive Shaft. Fits 6000 Series	SP2040-61
DC40-90	Rear Countershaft To Seed Meter Feed Shaft. Fits 8000 Series	SP40-90
DC40-122	Rear Countershaft To Front Main Drive Shaft. Fits 8000 Series	SP40-122

US Part No. Description/MUO

Import Part No.

Row-Unit Drive Chain

DC41-120	Seed Hopper Meter Drive. Fits 5100, 5700 Series	SP41-120
DC41-110	Seed Hopper Meter Drive. Fits 6000 Series	SP41-110
DC41-116	Seed Hopper Meter Drive. Fits 8000 Series	SP41-116
DC41-105	Insecticide/Herbicide Meter Drive. Fits 5100, 5700 Series	SP41-105
DC41-97	Insecticide/Herbicide Meter Drive. Fits 6000 Series	SP41-97
DC41-94	Insecticide/Herbicide Meter Drive. Fits 8000 Series	SP41-94

US Part No. Description/MUO

Import Part No.

Main Wheel Drive Chain

DC2050-63	Main Wheel Drive Chain. Fits 5100, 5700, 6000 Series	SP2050-63
DC50-126	Main Wheel Drive Chain. Fits 8000 Series	SP50-126



Link Plate Pitch Holes go through a 3-step process to ensure a uniform press fit.



Bushing Orientation aligns the formed bushing so the seam does not contact the pin during a load.



Case-Hardened Pins provide the perfect balance between wear resistance and durability.



Preloading sets each part within the chain to eliminate elongation.



Shot Peening imposes an internal stress for improved strength.



Planting & Tillage

SUNFLOWER AND WHITE PLANTER

